

Part Number: CA-1H-BOX (used with the Corbin saddle)

Description: Trunk box

Fitment: 2008 Can-Am Spyder

Revision: 1



Tools Required	Parts List
5mm Hex Key (Allen wrench) 6mm Hex Key (Allen wrench) 13mm Socket Wrench T-30 Torx Wrench Loctite® or similar thread lock compound.	1 Corbin trunk box (complete) 1 Corbin taillight 4 m8 Chrome flat washers 4 m8 x 25 Chrome button head Allen bolts 3 m8 x 40 Cap screws 3 Splice connectors

NOTE: We recommend the use of a thread lock product such as Loctite® when assembling parts on your motorcycle.

1. Remove your Corbin saddle and unplug the seat sensor. Set them aside (Figures 1 & 2).



FIG 1

2. Remove the small center tail piece located behind the passenger seat using a T-30 torx wrench (Figures 3 & 4).

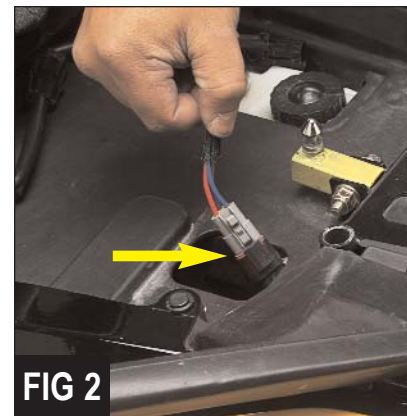

FIG 2

3. Pull out your right signal plug so you can locate the bundled group of wires (Figure 5).



FIG 3

4. Among the wires, you will find one each colored BLACK, WHITE and ORANGE. Apply one of the included splices to each wire (Figure 6).



FIG 4

5. Next, using a 13mm socket wrench, remove the three bolts on the Spyder seat mount (Figure 7).

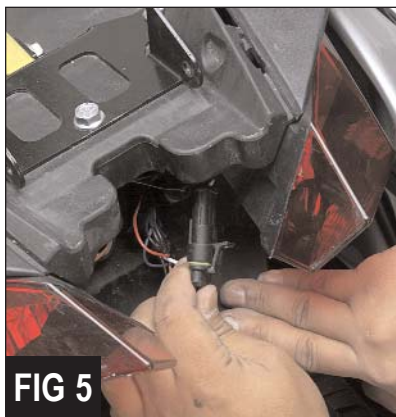

FIG 5

6. Connect the wires from the Corbin taillight to the wires on the bike (Figure 8).

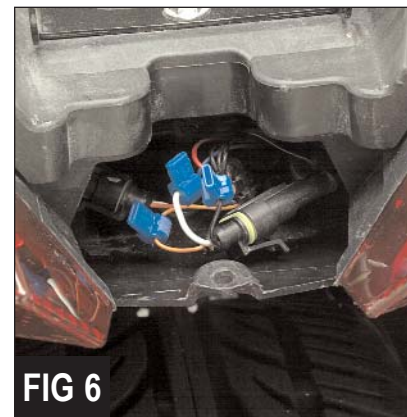

FIG 6

CORBIN

CAN-AM SPYDER

Red	to	Orange
Black	to	Black
White	to	White

7. Now carefully and neatly tuck the wires all away back where it was.

8. Install the taillight bracket to the seat mounting bracket and secure with the supplied m8 x 40 cap screws, using a 6mm Allen wrench (*Figure 9*). Use Loctite® and tighten to 10-12 ft. lbs.

9. Test the lighting to make sure everything works as it should. Lighting should provide the following:

- Running light
- Brake light

10. Now go back and plug in your seat sensor, your pigtails for the heated seat and then reinstall your Corbin saddle.

NOTE: Don't forget to remove the key from the seat.

11. Place your Corbin trunk onto the mounting bracket and secure the four locations with the provided m8 chrome flat washers and m8 x 25 chrome button head Allen bolts, using a 5mm Allen wrench (*Figure 10*). Tighten to 10-12 ft. lbs. and use Loctite®.

Remember to take care and use good judgement when loading the Corbin trunk. Although it is capable of handling a great deal of luggage, you do not want to overload your bike or carry weight too high.

Enjoy the ride!

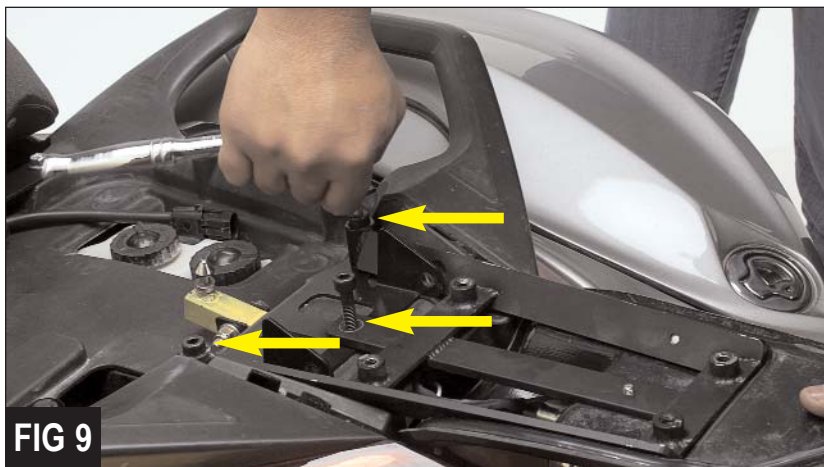
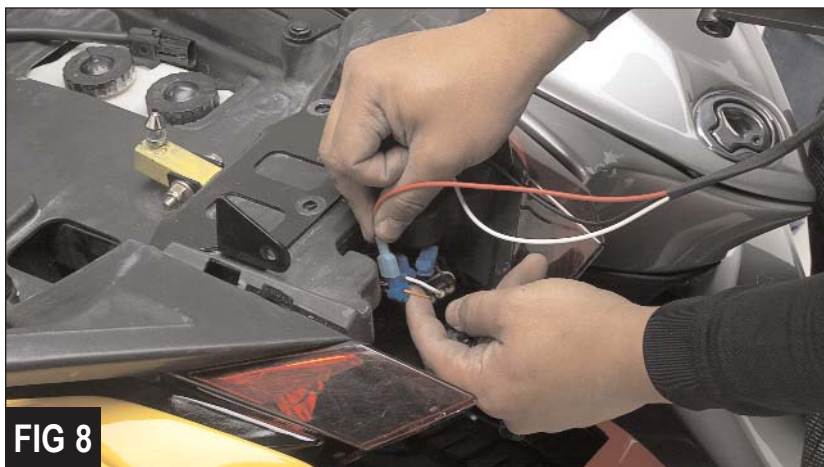
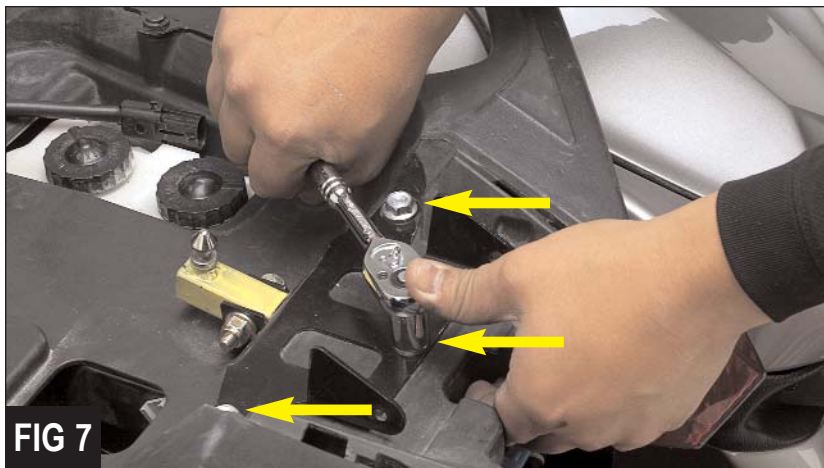

Questions? Give us a call!
800-223-4332
daytona@corbin.com